

**NOTES: (UNLESS OTHERWISE SPECIFIED)**

1. The interface comply with CECC 22340.
2. Part must be packaged to avoid any damaged during transportation.
3. After crimping dimension should be AFSW 3.25.

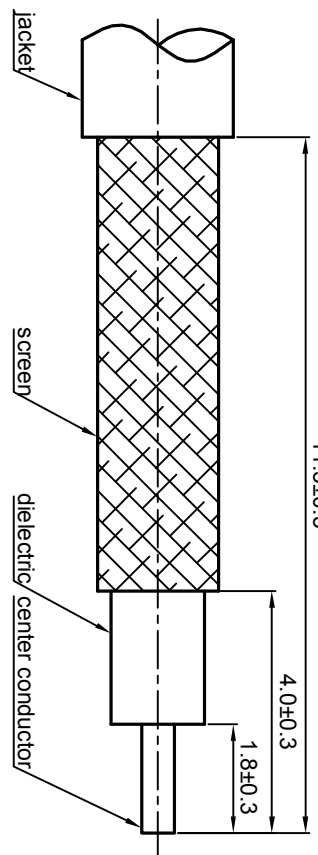
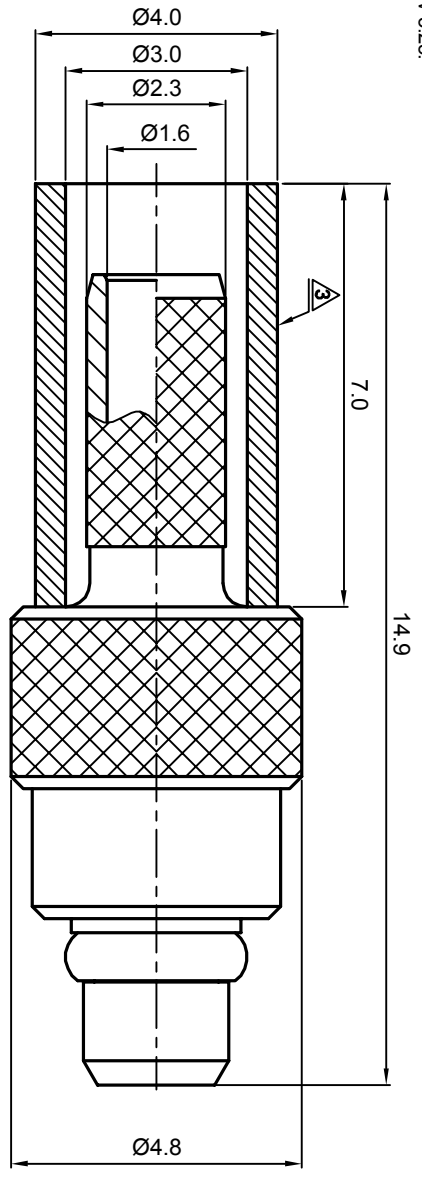

REV.	DESCRIPTION	APPROVED	DATE	EON

<b>MATERIAL</b> SEE BOM FOR DETAILS		<b>TOLERANCES</b> Oplate X ±1 1place X ±0.1 2place XX ±0.05 Angle ±5°		<b>THIRD ANGLE PROJECTION</b> 		<b>TITLE</b> MMCX, PLUG, CABLE	
<b>FINISH</b> SEE BOM FOR DETAILS		Remove burrs and sharp edges 		GENERAL ECCENTRICITY <input checked="" type="checkbox"/> 0.06		DWG. NO. 5121.MMCX.PSC.06.111	
Plating part to be touched by gloves Dimension apply before plating XXX - measuring point for plating		DRAWN BY Danny		NAME Danny		DATE 05NOV07	
<b>SURFACE</b>		<b>VOLUME</b>		CHECKED BY		APPROVED BY	
NOTICE: Those drawings and specifications are the property of ZEETEQ CORPORATION and used only for the specify purpose authorised by ZEETEQ		SCALE 8:1		DO NOT SCALE DRAWING		SIZE A4	
REV.		SHEET		1 of 1		S1	

