

NOTES: (UNLESS OTHERWISE SPECIFIED)

- Interface comply with IEC 169-10.
- Part must be packaged to avoid any damaged during transportation.

After crimping dimension should be AF/SW 3.25.

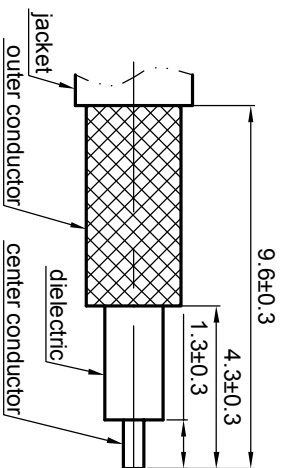

Recommended cable stripping dims

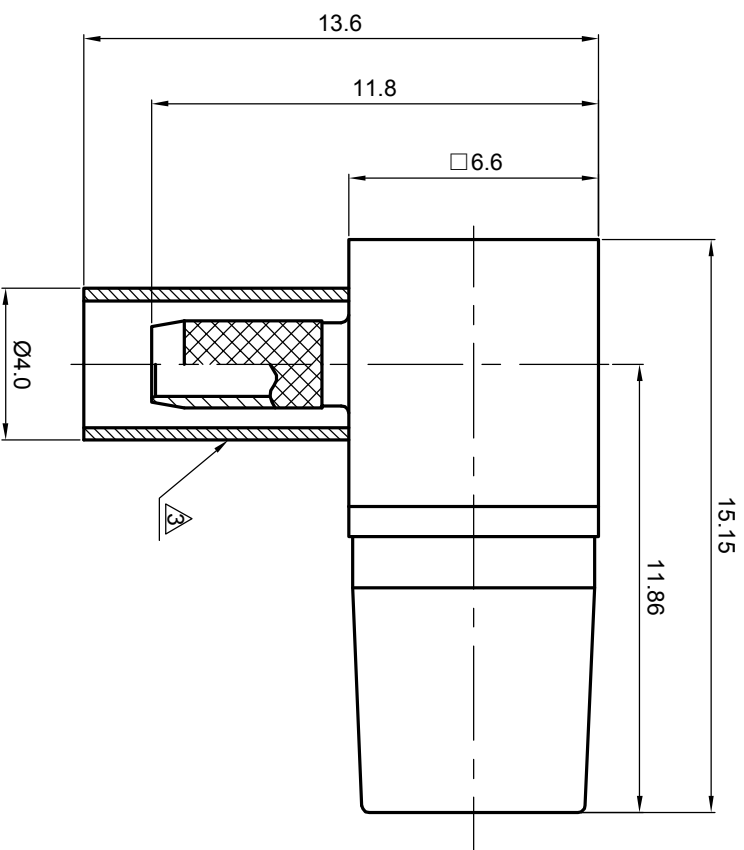

REV.	DESCRIPTION	APPROVED	DATE	EON

MATERIAL		SEE BOM OF DETAILS		TOLERANCES		THIRD ANGLE PROJECTION		TITLE	
SEE BOM OF DETAILS		SEE BOM OF DETAILS		Opface X ±1 1place X ±0.1 2place XX ±0.05 Angle ±5°				Zee-teq SMB, jack, cable	
FINISH		Remove burrs and sharp edges		-0.2 +0.2		GENERAL ECCENTRICITY <input type="checkbox"/> 0.06		DWG. NO. 5153.SMB.JRC.07.111	
Plating part to be touched by gloves				DRAWN BY Billy		DATE 8 Nov 07		SCALE 5:1	
Dimension apply before plating				CHECKED BY		APPROVED BY		DO NOT SCALE DRAWING	
XXX - measuring point for plating		NOTICE: Those drawings and specifications are the property of ZEETEQ CORPORATION and used only for the specify purpose authorised by ZEETEQ						SIZE A4	
SURFACE		VOLUME						SHEET 1 of 1	

1.6