

**NOTES: (UNLESS OTHERWISE SPECIFIED)**

1. Interface comply with IEC 169-15.
2. Part must be packaged to avoid any damages during transportation.
3. After crimping dimension should be AF/SW 3.25.

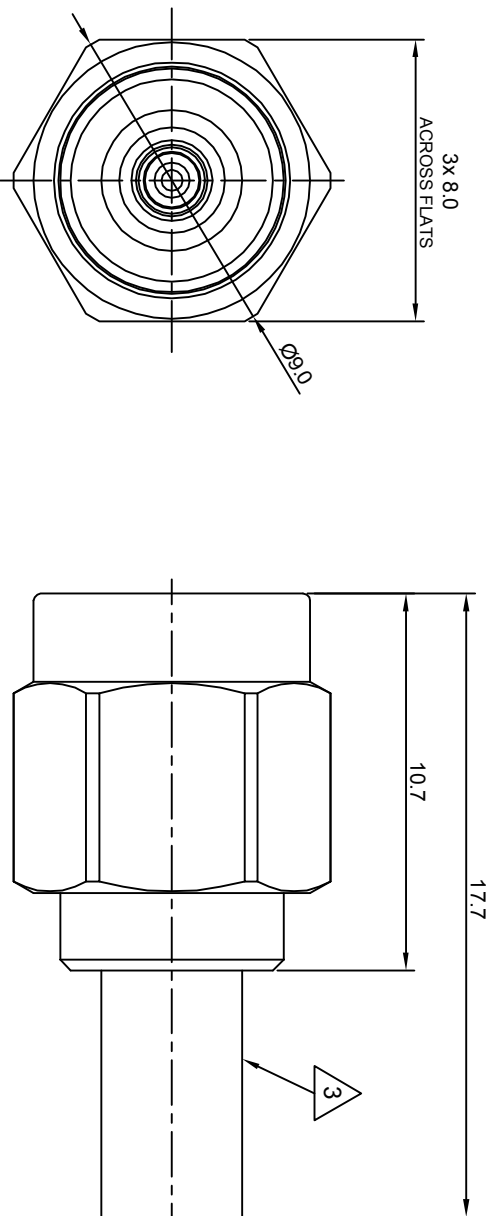

recommended cable stripping dims

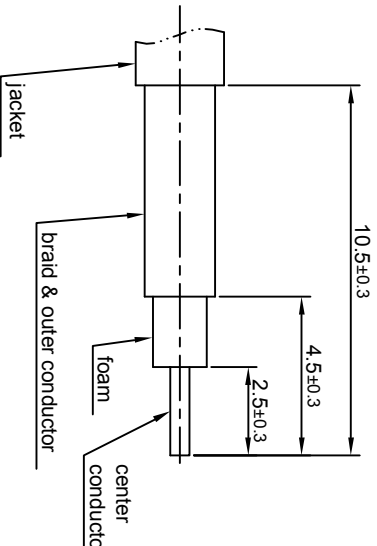

REV.	DESCRIPTION	APPROVED	DATE	ECN
A	Rel to production	Johnny	16Nov07	

MATERIAL SEE BOM		THIRD ANGLE PROJECTION		TITLE <b>SMA, plug, cable mount</b>	
FINISH SEE BOM		GENERAL ECCENTRICITY <input checked="" type="checkbox"/> 0.06		DWG NO. 5003.SMA.PSC.06.111	
Plating part to be touched by gloves		TOLERANCES		SCALE 5:1	
Dimension apply before plating		Optical X ±1		DO NOT SCALE DRAWING	
XXX - measuring point for plating		1place X ±0.1		SIZE A4	
SURFACE		2place .XX ±0.05		SHEET 1 of 1	
VOLUME		Angle ±5°		REV. A	
Remove burrs and sharp edges		DRAWN BY Joy Zhou		DATE 11Oct07	
-0.1 +0.1		CHECKED BY Colin Dai		DATE 16Nov07	
APPROVED BY Johnny		DATE 16Nov07			
<p><b>NOTICE:</b> Those drawings and specifications are the property of ZEETEQ CORPORATION and used only for the specify purpose authorised by ZEETEQ</p>					

