

**NOTES: (UNLESS OTHERWISE SPECIFIED)**

- Interface comply with IEC 169-15.
- Part must be packaged to avoid any damaged during transportation.

REV.	DESCRIPTION	APPROVED	DATE	EON

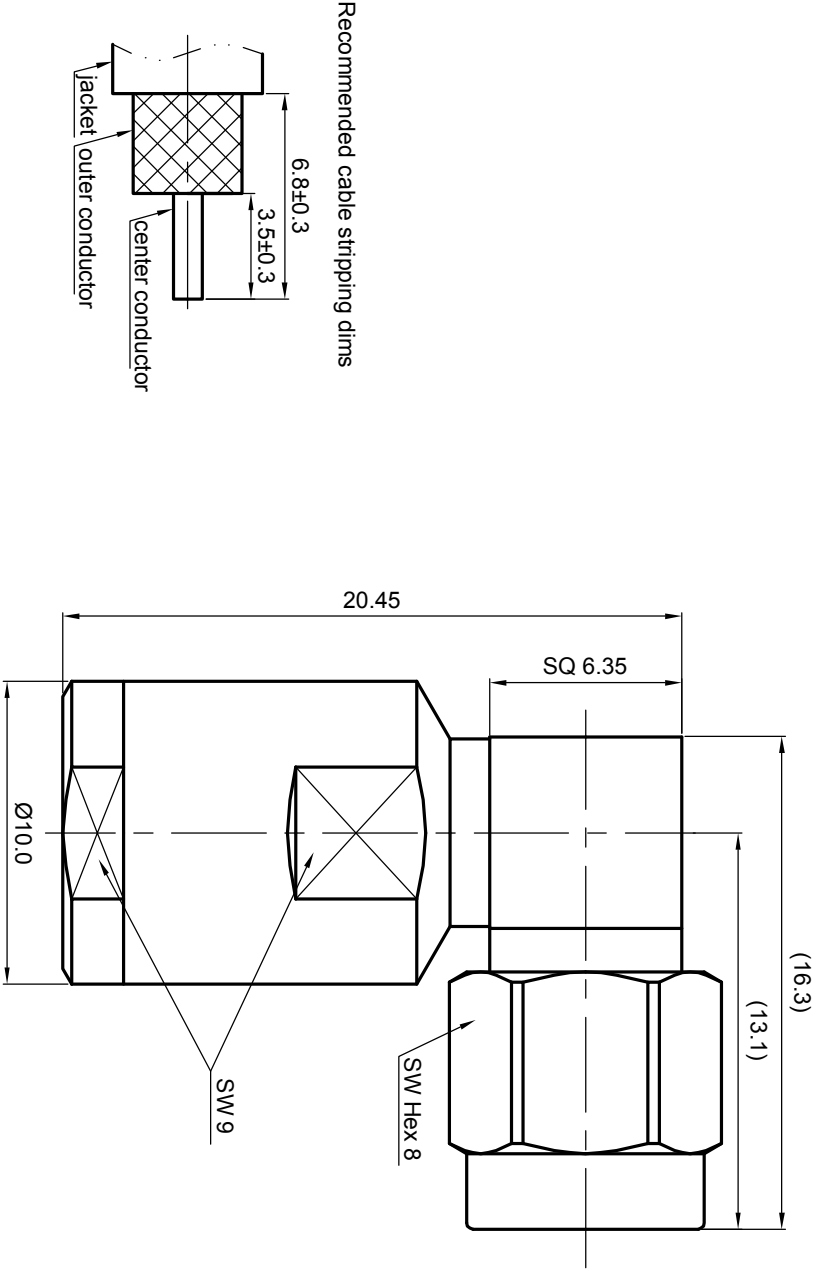

Recommended cable stripping dims

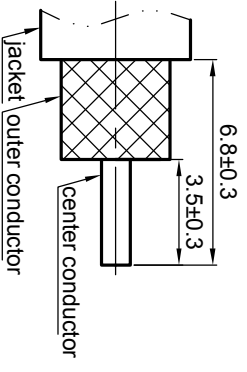

1.6

MATERIAL		SEE BOM OF DETAILS		TOLERANCES		THIRD ANGLE PROJECTION		TITLE	
SEE BOM OF DETAILS		SEE BOM OF DETAILS		Opface X ±1 1place X ±0.1 2place XX ±0.05 Angle ±5°				<b>Zee-teq</b>	
FINISH		SEE BOM OF DETAILS		Remove burrs and sharp edges 		GENERAL ECCENTRICITY <input checked="" type="checkbox"/> 0.06		TITLE <b>SMA,plug,cable</b>	
Plating part to be touched by gloves		SEE BOM OF DETAILS		-0.2 +0.2		DRAWN BY Billy Lei 11 Oct 07		DWG NO. 5204.SMA.PRC.09.111	
Dimension apply before plating		SEE BOM OF DETAILS		-0.2 +0.2		CHECKED BY		SCALE 4:1	
XXX - measuring point for plating		SEE BOM OF DETAILS		-0.2 +0.2		APPROVED BY		DO NOT SCALE DRAWING	
SURFACE		VOLUME		NOTICE: Those drawings and specifications are the property of ZEE-TEQ CORPORATION and used only for the specify purpose authorised by ZEE-TEQ		NAME DATE		SIZE A4	
						REV.		SHEET 1 of 1	
						S1			