

## Description

The SMB connectors feature a snap-on coupling mechanism which provides a fast and reliable connection in high-packing density.

The SMB is smaller in size than the SMA and excellent where engineers are concerned about circuit miniaturization. Typical application is inter- or intra-board connection of RF or digital signals. Zeeteq SMB connectors comply with IEC60169-10, and suitable for semi-rigid and flexible cables operating from DC to 4GHz.

## Configuration

plug straight cable connector.....	45
plug right angle cable connector.....	47
jack straight cable connector.....	48
jack right angle cable connector.....	49
Bulkhead receptacle.....	50
PCB mount receptacle.....	51

## Interface Scheme

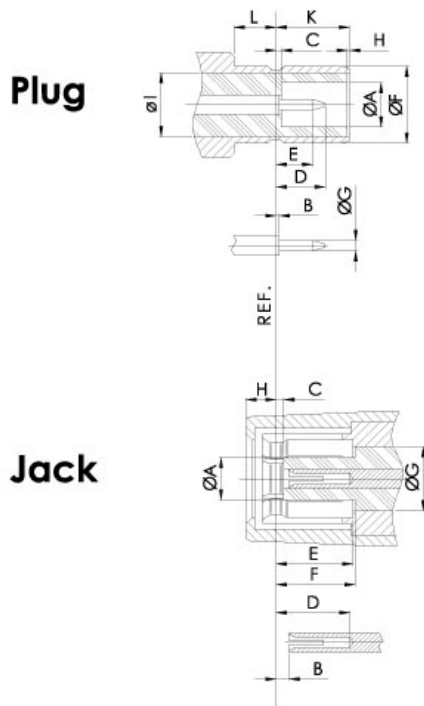

## Interface Dimensions

	Plug		Jack		
	min.	max.	min.	max.	
A	2.08	-	-	2.06	A
B	-	0.18	0.18	0.94	B
C	-	0.18	0.18	-	C
D	-	2.97	2.97	-	D
E	1.32	-	3.58	-	E
F	3.66	3.71	3.58	-	F
G	0.48	0.53	3.05 nom.		G
H	0.00	-	-	1.63	H
I	3.05 nom.		-	-	I
K	3.33	3.58	-	-	K
L	1.65	-	-	-	L

## SPECIFICATION

### ELECTRICAL DATA

Impedance	50Ω
Frequency range	DC-4GHz
RF leakage @ 1GHz	≥ 55dB
Dielectric withstanding voltage (at sea level, in Vrms,50Hz)	≥ 750
Working voltage(at sea level, in Vrms,50Hz)	≤ 250
Insulation resistance	≥ 1000MΩ
Contact resistance	
-center contact	≤ 5.0mΩ
-outer contact	≤ 2.5mΩ

### MECHANICAL DATA

Engagement force	8-63N
Disengagement force	8-63N
Contact captivation	≥10 N
Durability(matings)	≥ 500

### ENVIRONMENTAL DATA

Temperature range	-65°C- +165°C
Climatic category	IEC 55/155/21
Thermal shock	MIL-STD-202,Method 107, Condition B
Moisture resistance	MIL-STD-202,Method 106
Corrosion	MIL-STD-202,Method 101, Condition B
Vibration	MIL-STD-202,Method 204, Condition D
Shock	MIL-STD-202,Method 213, Condition I

### MATERIAL DATA

PART	MATERIAL	PLATING
Body, outer contact, pin contact	Brass	Gold, Trimetal
Socket contact	Beryllium copper	Gold
Ferrule	Copper Brass	Gold, Trimetal
Spring finger	Beryllium copper	Gold, Trimetal
Insulator	PTFE	
Gasket	Silicone rubber	

## PLUG STRAIGHT CABLE CONNECTORS

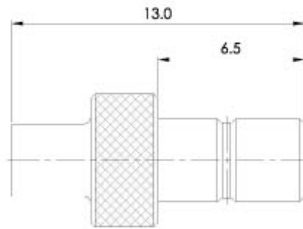

Part number	Cable code	Cable	Center contact	Outer contact	Body plating
5138.SMB.PSC.02.110	02	UT85 RG405	solder	solder	gold

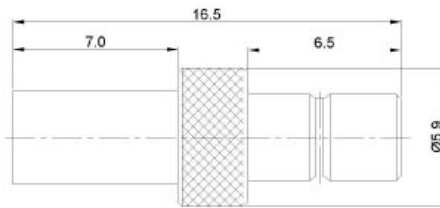

Part number	Cable code	Cable	Center contact	Outer contact	Body plating
5139.SMB.PSC.05.111	05	RG178 RG196	solder	crimp	gold

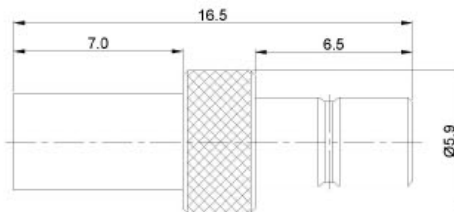

Part number	Cable code	Cable	Center contact	Outer contact	Body plating
5140.SMB.PSC.06.111	06	RG174 RG188 RG316	solder	crimp	gold
5141.SMB.PSC.07.111	07	RG316D	solder	crimp	gold

## PLUG STRAIGHT CABLE CONNECTORS

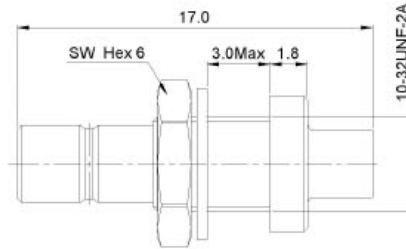

Part number	Cable code	Cable	Center contact	Outer contact	Body plating
5238.SMB.PSC.02.111	02	UT85 RG405	solder	solder	gold

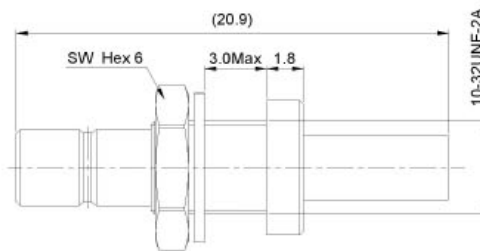

Part number	Cable code	Cable	Center contact	Outer contact	Body plating
5239.SMB.PSC.05.111	05	RG178 RG196	solder	crimp	gold

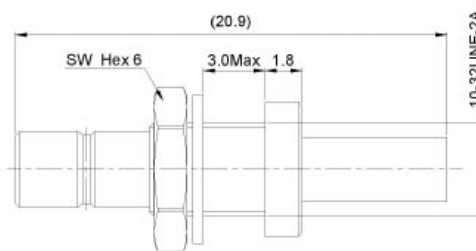

Part number	Cable code	Cable	Center contact	Outer contact	Body plating
5240.SMB.PSC.06.111	06	RG174 RG188 RG316	solder	crimp	gold
5241.SMB.PSC.07.111	07	RG316D	solder	crimp	gold

## PLUG RIGHT ANGLE CABLE CONNECTORS

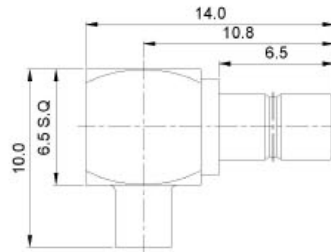

Part number	Cable code	Cable	Center contact	Outer contact	Body plating
5142.SMB.PRC.02.111	02	UT85 RG405	solder	solder	gold

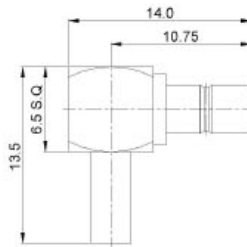

Part number	Cable code	Cable	Center contact	Outer contact	Body plating
5143.SMB.PRC.05.111	05	RG178 RG196	solder	crimp	gold

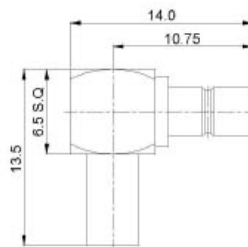

Part number	Cable code	Cable	Center contact	Outer contact	Body plating
5144.SMB.PRC.06.111	06	RG174 RG188 RG316	solder	crimp	gold
5145.SMB.PRC.07.111	07	RG316D	solder	crimp	gold

## JACK STRAIGHT CABLE CONNECTORS

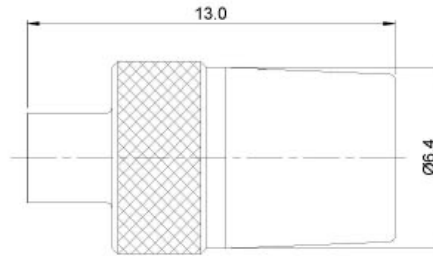

Part number	Cable code	Cable	Center contact	Outer contact	Body plating
5146.SMB.JSC.02.110	02	UT85 RG405	solder	solder	gold

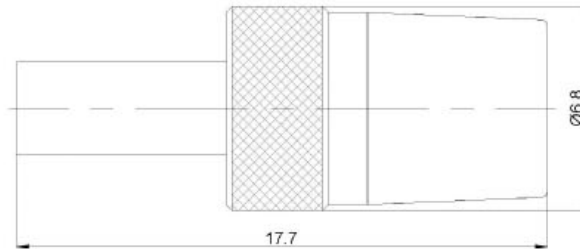

Part number	Cable code	Cable	Center contact	Outer contact	Body plating
5147.SMB.JSC.05.111	05	RG178 RG196	solder	crimp	gold

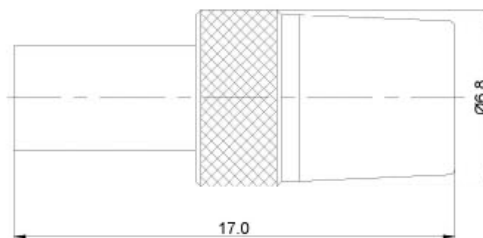

Part number	Cable code	Cable	Center contact	Outer contact	Body plating
5148.SMB.JSC.06.111	06	RG174 RG188 RG316	solder	crimp	gold
5149.SMB.JSC.07.111	07	RG316D	solder	crimp	gold

## JACK RIGHT ANGLE CABLE CONNECTORS

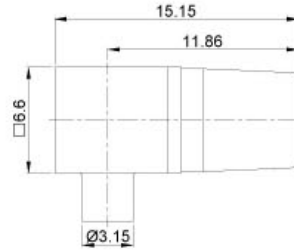

Part number	Cable code	Cable	Center contact	Outer contact	Body plating
5150.SMB.JRC.02.111	02	UT85 RG405	solder	solder	gold

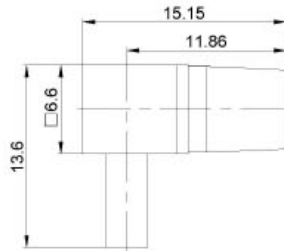

Part number	Cable code	Cable	Center contact	Outer contact	Body plating
5151.SMB.JRC.05.111	05	RG178 RG196	solder	crimp	gold

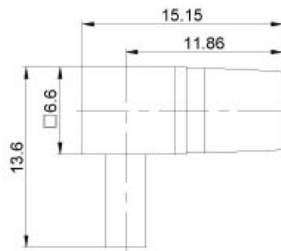

Part number	Cable code	Cable	Center contact	Outer contact	Body plating
5152.SMB.JRC.06.111	06	RG174 RG188 RG316	solder	crimp	gold
5153.SMB.JRC.07.111	07	RG316D	solder	crimp	gold

## BULKHEAD RECEPTACLES

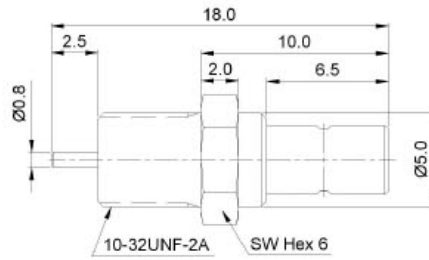

Part number	Center contact	Body plating	Notes
6083.SMB.PSB.00.110	coaxial rod	gold	flush dielectric, front mount

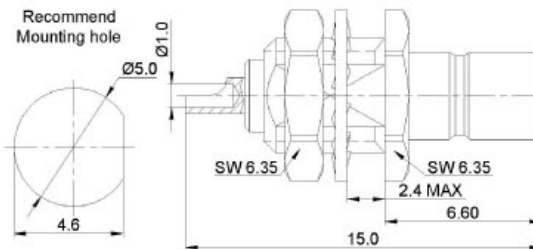

Part number	Center contact	Body plating	Notes
5987.SMB.PSB.00.111	solder cup	gold	extended dielectric, front mount

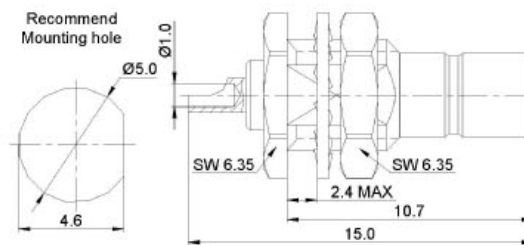

Part number	Center contact	Body plating	Notes
5988.SMB.PSB.00.111	solder cup	gold	extended dielectric, rear mount



## PCB MOUNT RECEPTACLES

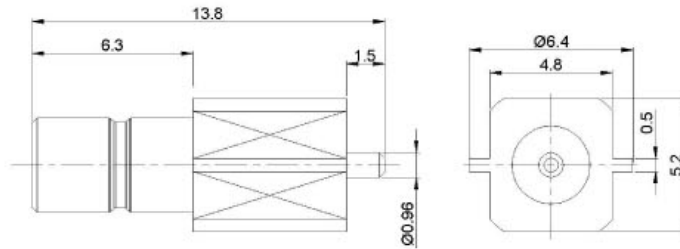

Part number	Center contact	Body plating	Notes
5985.SMB.PSE.00.110	Solder tab	gold	edge mount

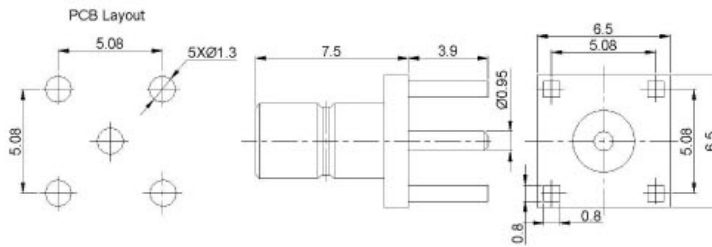
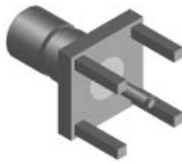

Part number	Center contact	Body plating	Notes
6098.SMB.PST.00.110	through hole	gold	PCB through hole mount

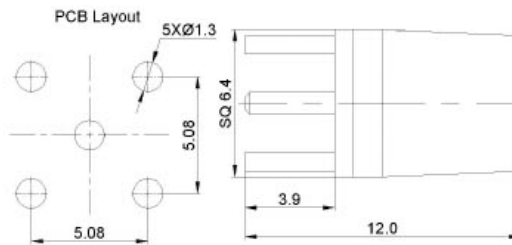
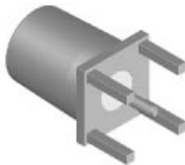

Part number	contact	Body plating	Notes
6099.SMB.JST.00.111	through hole	gold	PCB through hole mount

## PCB MOUNT RECEPTACLES

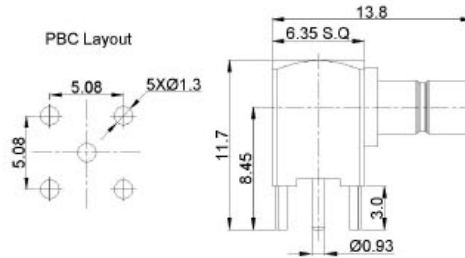

Part number	Center contact	Body plating	Notes
5986.SMB.PRT.00.111	through hole	gold	PCB through hole mount

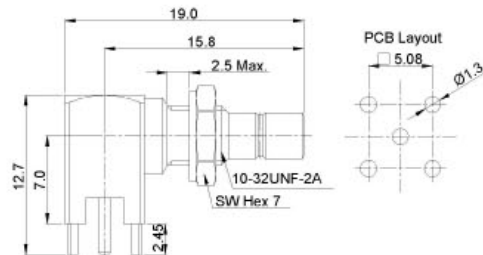

Part number	Center contact	Body plating	Notes
5997.SMB.PRT.00.111	through hole	gold	PCB through hole mount

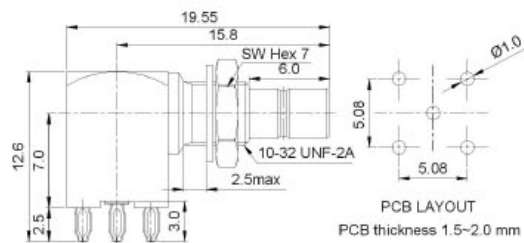

Part number	Center contact	Body plating	Notes
5998.SMB.PRP.00.111	press fit pin	gold	PCB press fit mount